

Now consider an identical layout to above, but with a ban on motor traffic using the "side road", and we have the Gonville Place crossing (below). THERE IS NO OTHER DIFFERENCE !

In order to carry out a productive trial, ensure that the following is carried out:

1. If a crossing request is made for both cycle and pedestrian crossings, allow cyclists to go first.

Phase ② Precisely as above

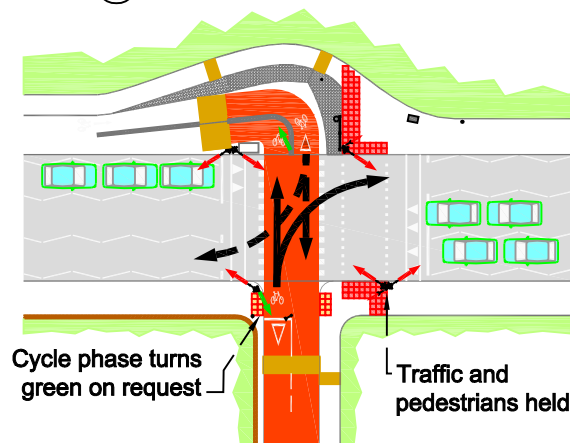

2. It is likely that most pedestrians will cross with the cycle phase, against a red light, rather than waiting for their own phase.
3. This will demonstrate that pedestrians are not concerned by turning cyclists and would rather mix than wait.
4. The absence of accidents will prove it is safe.
5. Conclusions: There never was any need for a turning ban.



**Scheme:** Gonville Place Crossing  
Cambridge

**Title:** Phasing of crossing  
as road junction

**Sheet no:** 01

**Revision:** -

**Date:** May 07

**Drawn by:** AM